



Not to scale.



MATERIAL SPECIFICATIONS

Polypropylene

PRODUCT DESCRIPTION

The Thermal-Grip[®] BT Washer is a 2" diameter plastic washer used with barrelstyle brick ties to attach rigid insulation. Dual prongs enable pre-spotting for on-the-wall anchor assembly. Flexible perimeter flattens without tearing insulation facer.

PRODUCT SPECIFICATIONS

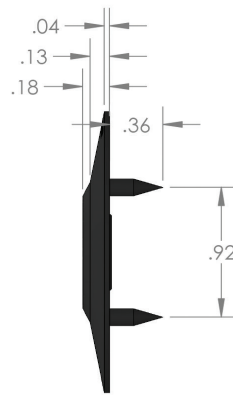
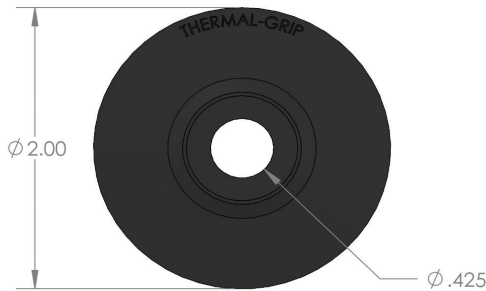

Basis of Design: Thermal-Grip[®] BT Washers as manufactured by TRUFAST.

Application: Washers to attach extra thick mineral wool layers. For use with SIP TP, SIP HD, or SIP LD as described above. Large 5/8 inch (16 mm) SIP screw head design recesses into brick tie washer for a flush profile.

Description: Washers only, not paired with screws.

- a. Solid plastic cap and flexible perimeter seal penetration of screw.
- b. Prongs to enable pre-spotting into insulation for on-the-wall screw assembly.
- c. Flexible perimeter flattens without tearing insulation facer for air-barrier performance.
- d. Carbon Black UV Inhibitor for exposure protection during course of construction.

PRODUCT SELECTION

Part No.	Part Diameter	Pkg. Qty.	Pkg. Wt.
TGPB-2000	2" (51mm)	1,000 pcs.	7.3 lbs.

PRODUCT FEATURES

- 2" diameter.
- Pre-spottong prongs.
- Carbon Black UV stabilizers.
- Rigid insulation manufacturer approved.
- Flexible perimeter compresses and seals against air and water penetration of foam insulation.
- Made in USA.
- Patented and/or patents pending.

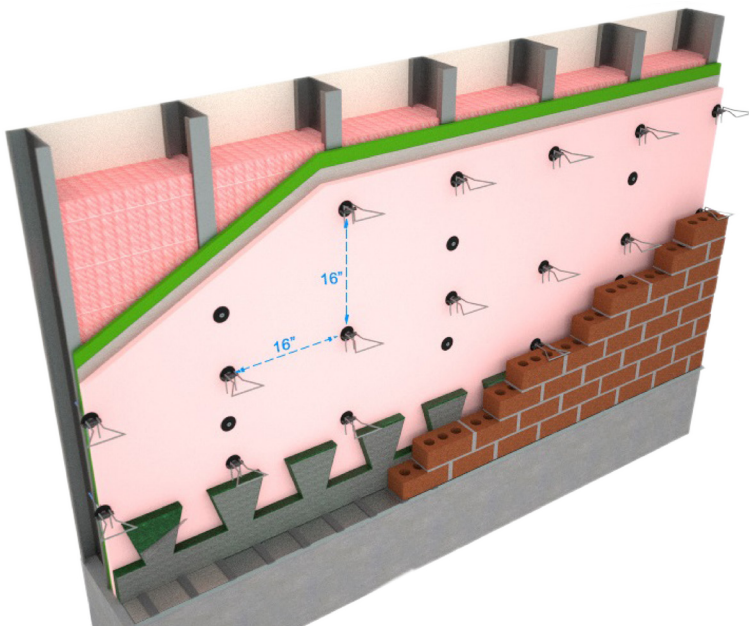

The Thermal-Grip BT Washer is used in the Thermal-Grip MVA Masonry Veneer Anchor assembly to address issues such as thermal bridging, air/water hold-out, and labor savings during installation. Learn more about the Thermal-Grip MVA at www.trufast.com.

Bulletin No. TFW-24081

DISCLAIMER

The information provided here is subject to change without notice. The performance specifications published in this TRUFAST[®] product literature are based on controlled laboratory tests and are intended as a guideline only. They are not guaranteed in any way by the ALTENLOH, BRINCK & CO. US, INC., since building design, engineering,

and construction, including workmanship and materials, are beyond the control of the manufacturer. The manufacturer recommends that pull-out tests be conducted to verify the substrate provides adequate pull-out values.