



Not to scale.



PRODUCT DESCRIPTION

The Grip-Plate TubeSeal® fastener from TRUFAST® is designed to help seal blind fastener penetrations of your WRB and air-barrier when mechanically attaching lath over continuous insulation. Lath must be mechanically attached, and often over continuous insulation and a WRB or air-barrier. With the Grip-Plate TubeSeal, installation enables sealing on the face of the WRB or air-barrier sandwiched between the substrate and the layer of continuous insulation.

Available pre-assembled with various screws including self-drilling (SDS in the chart below) for steel and HiLo for wood.



Self-Drilling Screw (SDS)



HiLo Screw

CODE & TESTING

ASTM E331*

ASTM E1186

ASTM E2357

ASTM C-1063

*Multiple assemblies of various insulations attached over various air/water barriers have been tested as per E331 up to 25 psf with no leakage. Please inquire for additional details.

MATERIAL SPECIFICATIONS

Fastener components made of various proprietary materials including:

Washer - Galvanized Steel

TubeSeal - Polyurethane

Screw - Carbon steel with proprietary exterior grade coating

PRODUCT SELECTION

Part No.	Fastener Type	Part Length for Nom. Thickness	Pkg. Qty.	Pkg. Wt.
GDTSGP-HL-1000	HiLo	1" insulation	500 pcs.	12 lbs.
GDTSGP-HL-1500	HiLo	1.5" insulation	500 pcs.	13 lbs.
GDTSGP-HL-2000	HiLo	2" insulation	500 pcs.	15 lbs.
GDTSGP-HL-2500	HiLo	2.5" insulation	250 pcs.	12 lbs.
GDTSGP-HL-3000	HiLo	3" insulation	250 pcs.	12 lbs.
GDTSGP-HL-3500	HiLo	3.5" insulation	250 pcs.	12 lbs.
GDTSGP-HL-4000	HiLo	4" insulation	250 pcs.	12 lbs.
GDTSGP-SD-1000	SDS	1" insulation	500 pcs.	12 lbs.
GDTSGP-SD-1500	SDS	1.5" insulation	500 pcs.	13 lbs.
GDTSGP-SD-2000	SDS	2" insulation	500 pcs.	15 lbs.
GDTSGP-SD-2500	SDS	2.5" insulation	250 pcs.	12 lbs.
GDTSGP-SD-3000	SDS	3" insulation	250 pcs.	12 lbs.
GDTSGP-SD-3500	SDS	3.5" insulation	250 pcs.	12 lbs.
GDTSGP-SD-4000	SDS	4" insulation	250 pcs.	12 lbs.

PRODUCT FEATURES

- Grip-Plate TubeSeal products are designed to seal blind fastener penetrations of a WRB or air-barrier.
- The Grip-Plate TubeSeal product is available in multiple lengths for insulation nominal thickness of 1", 1.5", 2", 2.5", 3", 3.5", and 4".
- UV resistant ether-based polyurethane tube is suitable for all weather climates.
- Patented and/or patent pending.

Test matrix included multiple configuration of insulation attached over multiple WRB types including:

	Sheet	Fluid	Self-Adhered	Integrated
ISO	X	X	X	X
XPS	X	X	X	X
Mineral Wool	X	X	X	X

Please contact for details on specific tested assemblies.

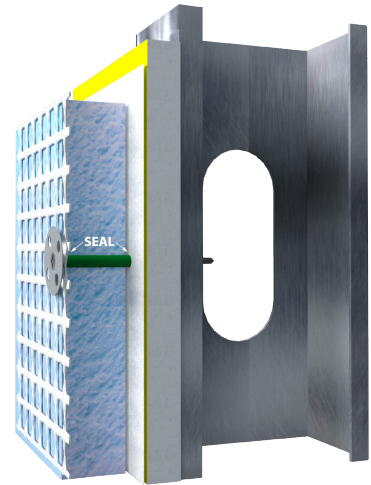

INSTALLATION GUIDELINES

Ensure tube length is appropriate for the thickness of insulation and lath material being installed (approximately 10% longer than insulation and lath material thickness) to ensure adequate compression and seal on underside of washer and surface of WRB.

Washer is designed to flatten on face of lath for adhesion of base coat.

Reference ASTM C-1063 or engineered system specification for recommended fastening patterns.

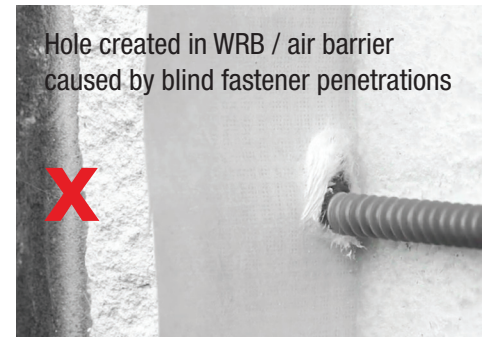

Hole created in WRB / air barrier caused by blind fastener penetrations



Grip-Plate TubeSeal® compresses against WRB / air barrier to help seal out air and water

Bulletin No. TFW-23111

DISCLAIMER

The information provided here is subject to change without notice. The performance specifications published in this TRUFAST® product literature are based on controlled laboratory tests and are intended as a guideline only. They are not guaranteed in any way by the ALTENLOH, BRINCK & CO. US, INC., since building design, engineering,

and construction, including workmanship and materials, are beyond the control of the manufacturer. The manufacturer recommends that pull-out tests be conducted to verify the substrate provides adequate pull-out values.